

71 63 151 Installing LED turn signal light

+ 71 63 651

Preparatory work

=> Removing and installing the middle stand special tool (motorcycles without centre stand) (Description in item: 46 52 511, Billed as a separate item)
 Removing seat

Core activity

(-) Removing both front flashing turn indicators

- Disconnect plug (1).

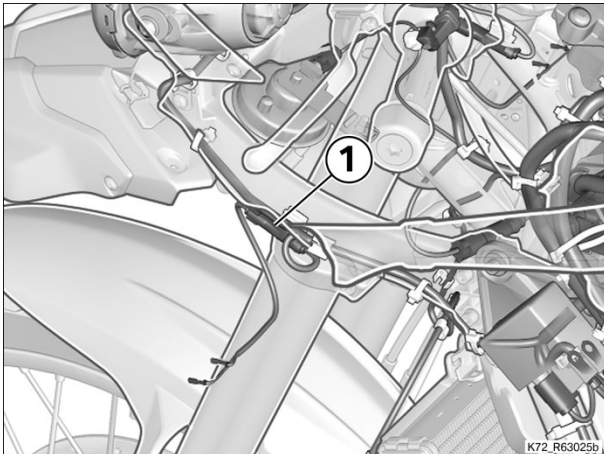

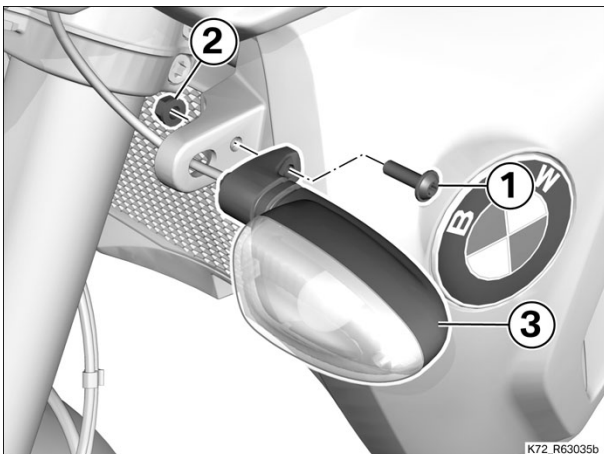

- Remove screw (1) with nut (2).
- Remove flashing turn indicator (3), taking care not to place tensile strain on the cable.

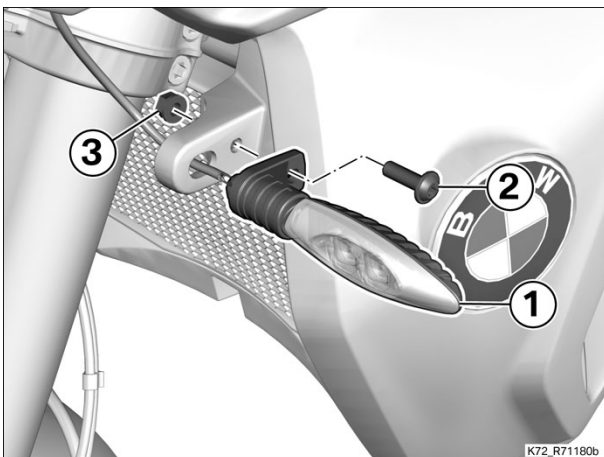

(-) Installing both LED front flashing turn indicators

- Insert flashing turn indicator (1) and install screw (2) with nut (3).



 Tightening torques		
Flashing turn indicator to air guide		
M6 x 20	2.5 Nm	

- Connect and secure plug (1).

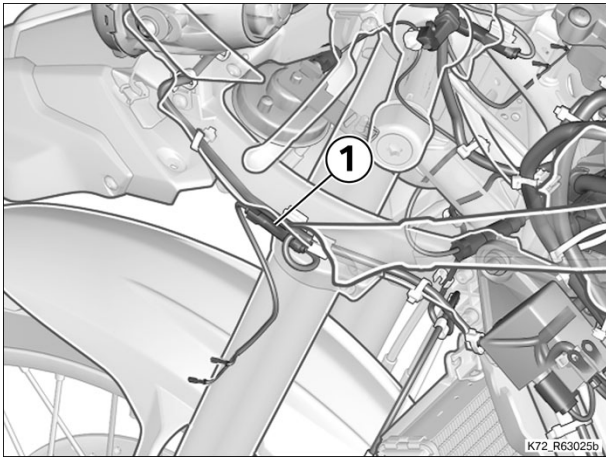

(-) Removing both rear flashing turn indicators

- Cut through the cable ties (arrows) and disconnect plug (1).

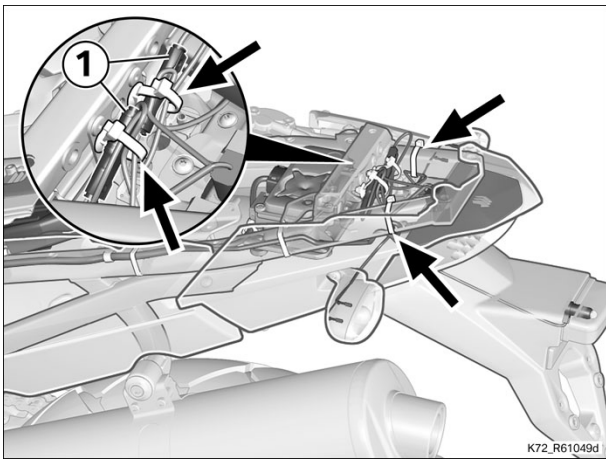

- Remove screw (1).
- Remove flashing turn indicator (2), taking care not to place tensile strain on the cable.

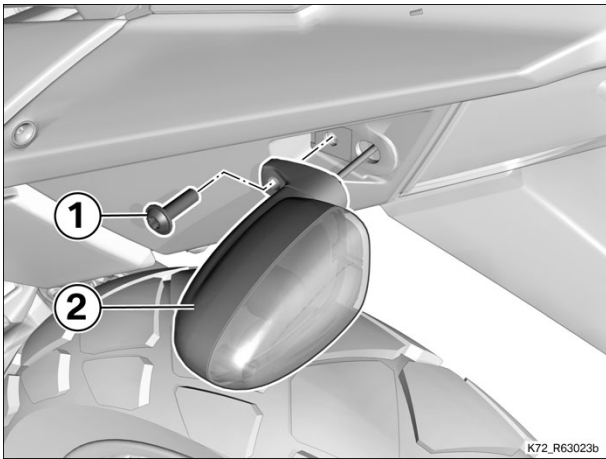

(-) Installing both LED rear flashing turn indicators

- Route the plug into position and install LED flashing turn indicator (2) with screw (1).

 Tightening torques		
Flashing turn indicator to rear side panel		
M6 x 20	2.5 Nm	

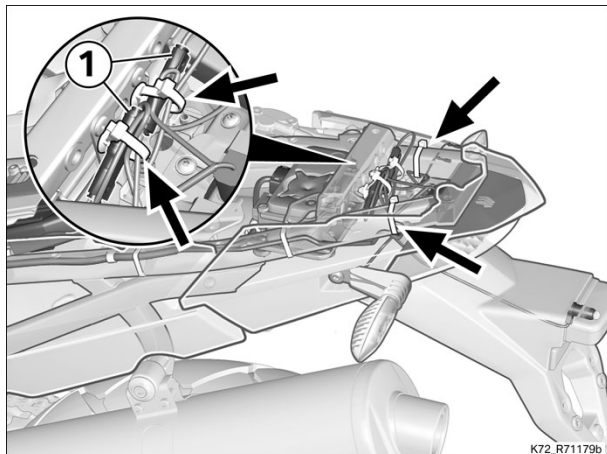
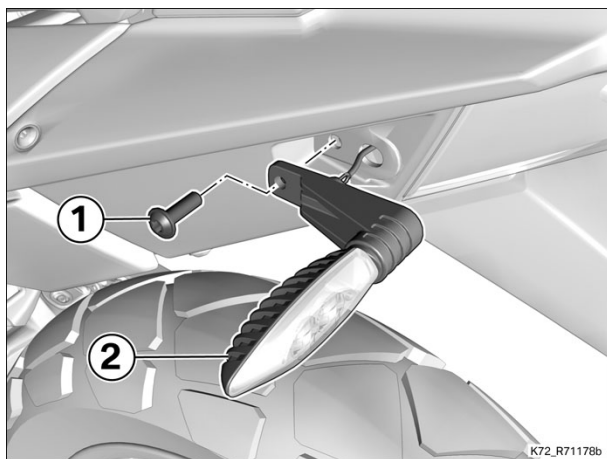

- Connect plug (1) and secure the excess cable with cable ties (arrows).

Finishing work

- Connecting BMW Motorrad diagnostic system to motorcycle
- Preparation for CIP (coding, individualisation and programming)
- Disconnecting BMW Motorrad diagnostic system from motorcycle
- Installing seat
- Final check of work performed